

Circular Shears

KSE 25 - KSE 100

.: CUTTING
.: FLANGING

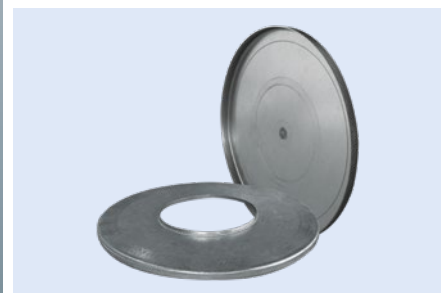
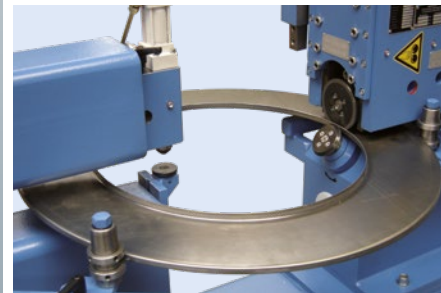
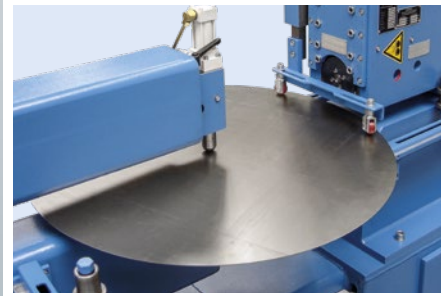

Design features

- Stable steel machine body and clamping bow
- Manually infeed of the top roll
- Manual sheet fixture
- Manual clamping bow adjustment for different disc diameters
- Infinitely variable main drive, both working knives electrically driven
- Sheet metal stop with scale in Y axis
- Subframe and 1 pair of cutting rolls for mild steel and stainless steel

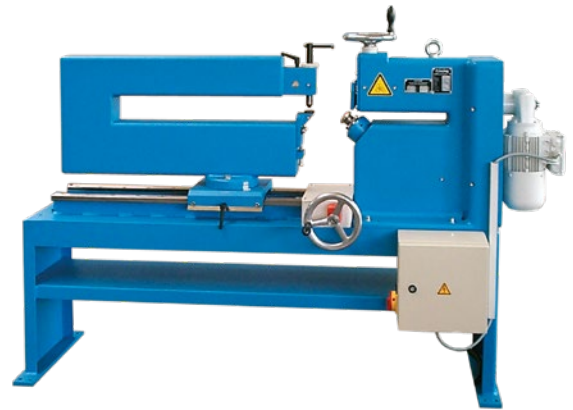

Special equipment

- Infinitely variable and controlled motor infeed of the top roll
- Pneumatically sheet fixture with changeable clamping plate
- Flanging device for inside and outside flanges
- Pneumatically downholder for flanging device
- Motor adjustment of different disc diameters
- Operation with touch screen and program memory for 200 programs
- Special cutting rolls for stainless and other materials

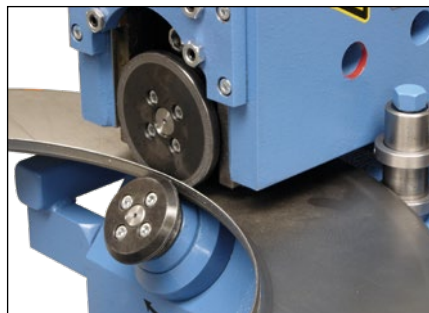

Technical data

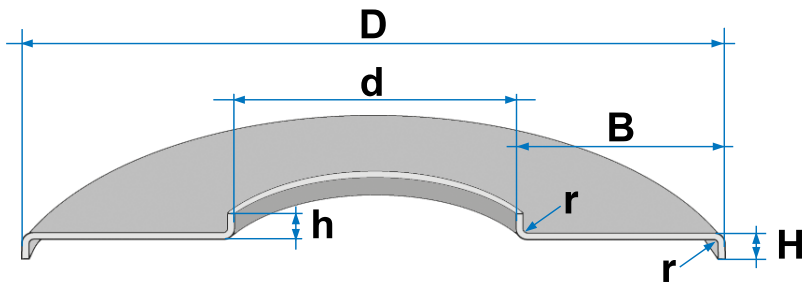

Model			KS 25/10	KS 25/15	KSE 25/10	KSE 25/15	KSE 31/12
Sheet thickness	400 N/mm ²	mm	2,5	2,5	2,5	2,5	4,0
	700 N/mm ²	mm	1,8	1,8	1,8	1,8	2,5
Circ.Blank-Ø min		mm	140	140	140	140	140
	Circ.Blank-Ø max	4-corner sheet	mm	1000	1500	1000	1500
8-corner sheet		mm	1300	2100	1300	2100	1500
Jaw capacity of knife body		mm	350	350	350	350	280
Jaw capacity of guide strap		mm	750	1100	750	1100	900
External flanging	Dmin	mm	140	140	140	140	200
	Dmax	mm	1300	2100	1300	2100	1500
	Hmax	mm	18	18	18	18	22
	rmin	mm	2	2	2	2	3
External- and Internal flanging	Dmax	mm	600	600	600	600	/
	Hmax	mm	15	15	15	15	
	dmin	mm	140	140	140	140	
	dmax	mm	520	520	520	520	
	hmin/max	mm	6/15	6/15	6/15	6/15	
	Bmin	mm	50	50	50	50	
rmin	mm	2	2	2	2		
Work speed	infinitely variable	m/min	---	---	10 - 45	10 - 45	6 - 30
Power motor main drive		kW	---	---	1,5	1,5	3,0
Weight with base frame		kg	420	460	450	490	1300
Size with base frame (L x W x H)		cm	240 x 60 x 150	290 x 60 x 150	240 x 70 x 150	290 x 70 x 150	250 x 90 x 170

Model			KSE 31/20	KSE 60/12	KSE 60/20	KSE 100/20	KSE 100/32
Sheet thickness	400 N/mm ²	mm	4,0	6,0	6,0	10,0	10,0
	700 N/mm ²	mm	2,5	4,0	4,0	6,0	6,0
Ronden-Ø min		mm	140	200	200	400	400
Ronden-Ø max	4-corner sheet	mm	2000	1200	2000	2000	3200
	8-corner sheet	mm	2600	1500	2600	2600	4000
Jaw capacity of knife body		mm	500	280	500	750	750
Jaw capacity of guide strap		mm	1500	900	1500	1500	2400
External flanging	Dmin	mm	200	400	400	600	600
	Dmax	mm	2600	1500	2600	2600	4000
	Hmax	mm	22	30	30	40	40
	rmin	mm	3	5	5	9	9
Work speed	infinitely variable	m/min	6 - 30	6 - 30	6 - 30	5 - 25	5 - 25
Power motor main drive		kW	3,0	5,5	5,5	9,2	9,2
Weight with base frame		kg	1500	1600	1900	3000	3500
Size with base frame (L x W x H)		cm	310 x 90 x 170	250 x 100 x 180	310 x 100 x 180	360 x 120 x 200	450 x 120 x 200

Further models and versions available on request!

Circular shears in special design

Circular shears with table and automatic work sequence

- Table can be lowered approx. 20mm manually
- Parallel infeed of the upper cutting roll
- Operation by 3 way foot switch
- special table with back stop
- Operation with touch screen and program memory for 200 programs possible

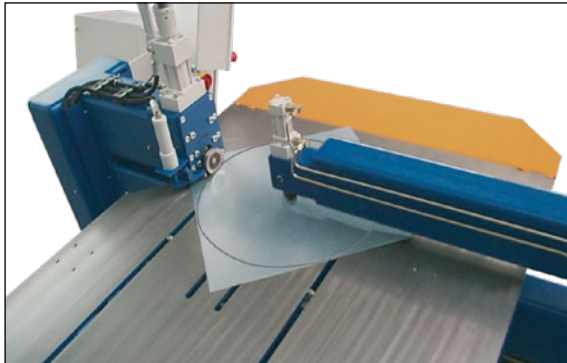
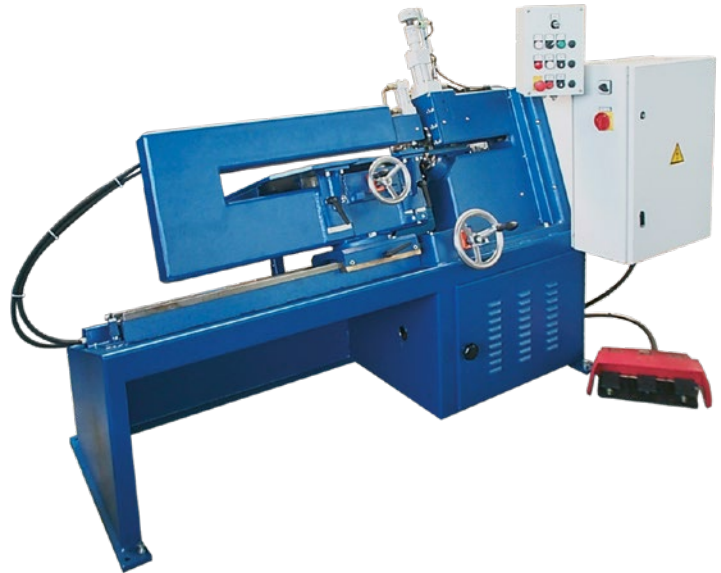

Clamping plates in special design

- For special hole and part specifications
- For extensive disc requirements



Supporting table with brush

- For special disc and sheet specification
- For supporting the disc during cutting

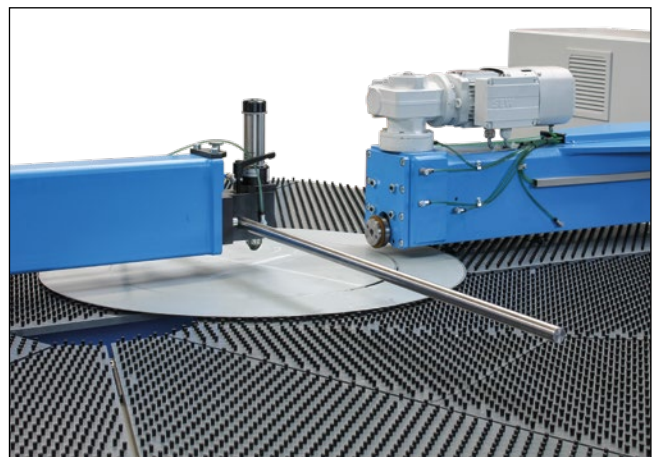

www.prinzing.eu

Prinzing
 ■ MASCHINENBAU ■

Peter Prinzing GmbH, Maschinenbau
 Siechenlach 2
 89173 Lonsee-Urspring (Germany)

Telefon: +49 7336 96100
 Telefax: +49 7336 9610-50
 E-Mail: info@prinzing.eu